

Pressure Balance Cartridge Temperature Adjustment Guide

Problem:

Lukewarm water temperature.

Solution:

Adjust red limit stop on the cartridge

1. Shutoff water to the shower valve.
Remove the handle as shown.

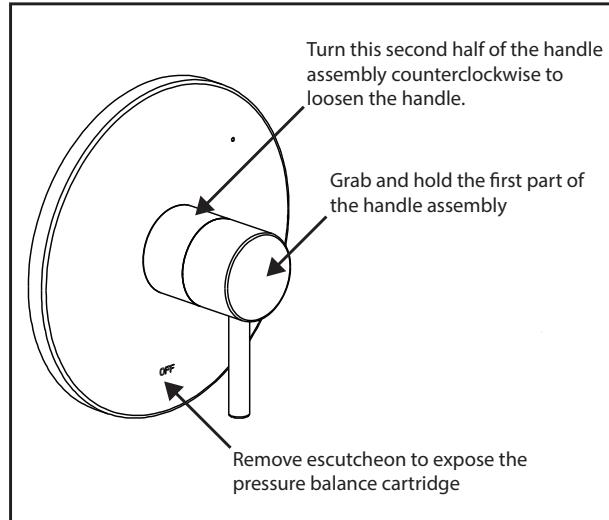

2. Remove escutcheon, threaded nipple and stem extension from the valve. See parts diagram.

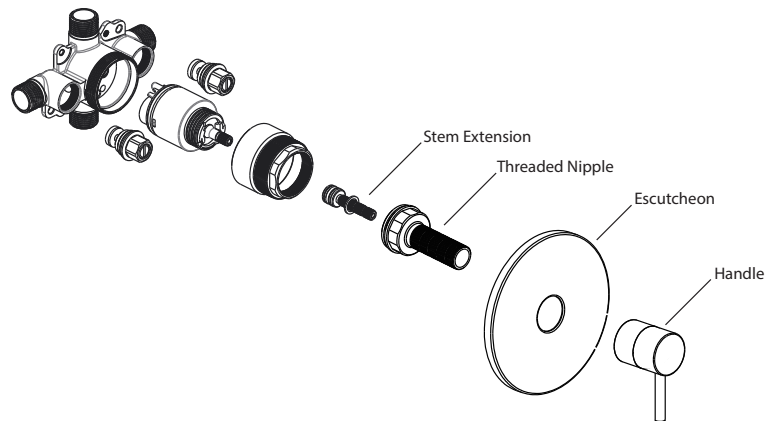

3. Pull the red limit stop off the cartridge.

4. Grab the brass tip with a pair of pliers and rotate the cartridge **CLOCKWISE** slowly until it stops. The cartridge should match the image on the right side.

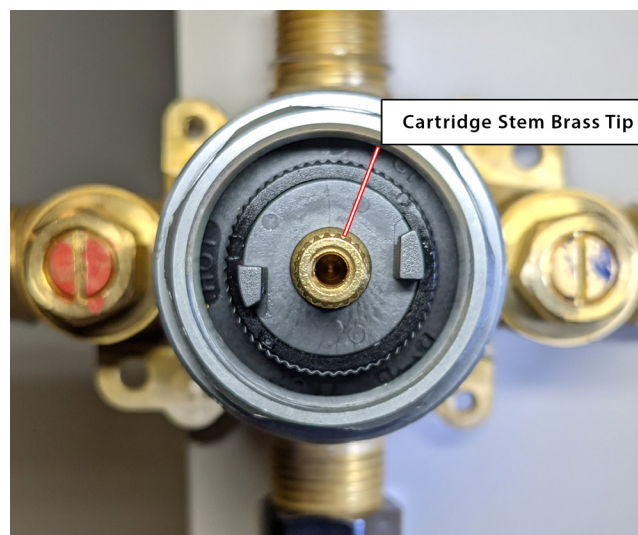

5. Align the first marker on the red limit stop to the cartridge temperature mark as shown.

6. Insert the red limit stop on the cartridge. (IMPORTANT! DO NOT use the cartridge without the red limit stop. This device can prevent accidental scalding)

7. Test water temperature by temporarily install the handle and turn on the water. Make adjustment as needed.

8. Reinstall the handle, escutcheon, threaded nipple and stem extension to complete the adjustment process.

